

Snap-Loc Systems

*Adjustable Length And
Interchangeable Components
With Easy Hand Assembly*

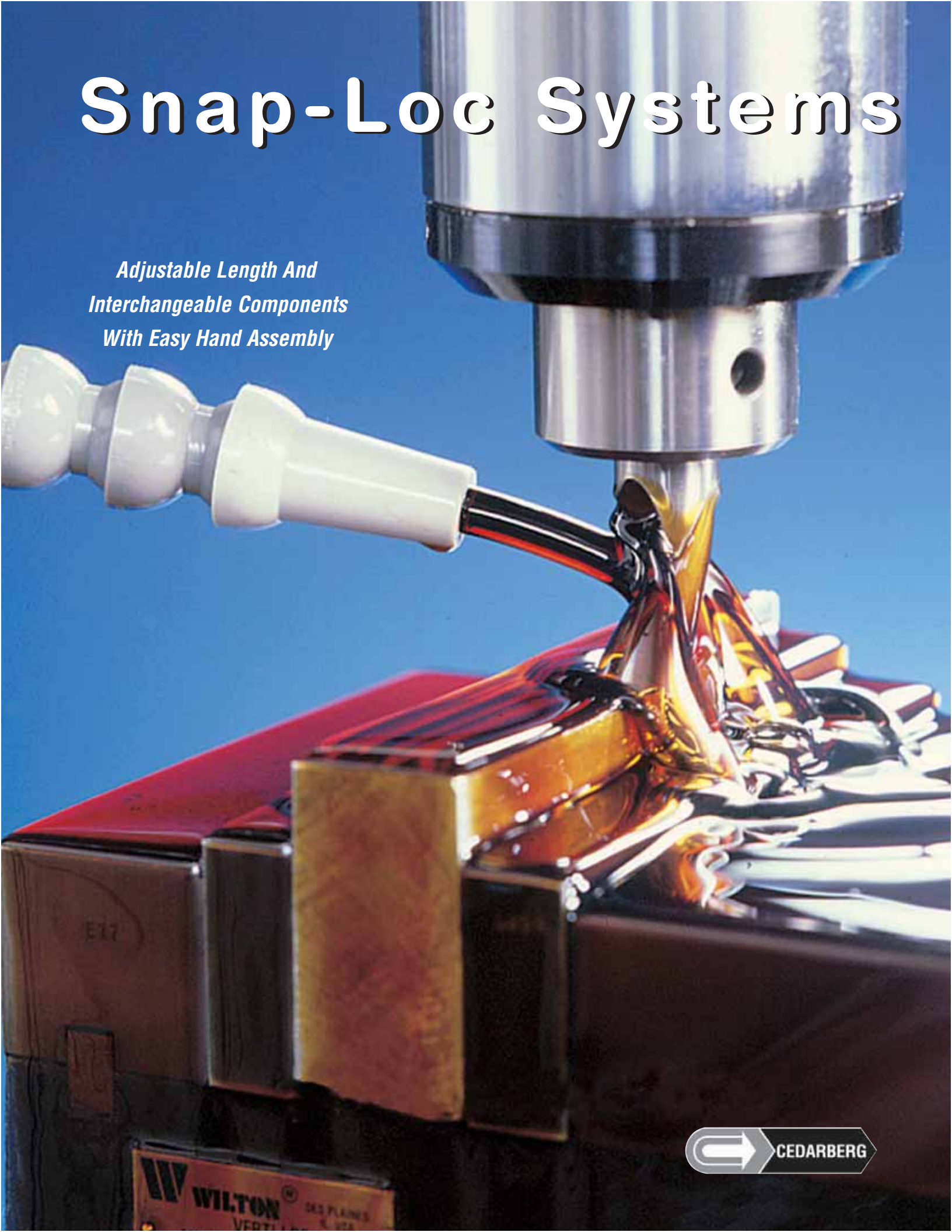

WILTON
VERTICAL
DES PLAINES
S. MONTANA

Snap-Loc Systems

Adjustable Length And Interchangeable Components With Easy Hand Assembly

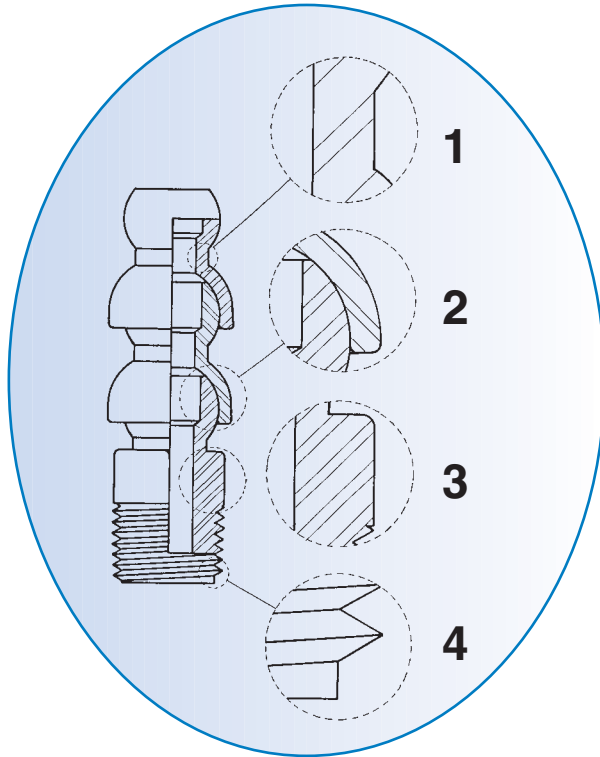

Fig. 1 Heavy-Duty Construction

Industrial grade wall thickness provides durable parts with long lasting performance.

Fig. 2 Bearing Surface & Snap Fit

Contribute to outstanding performance with respect to "jetting" and holding power. Snap-Loc Systems are designed for normal shop air and fluid pressures.

Fig. 3 Solid Hex Design

This solid hex design is superior to a ribbed design because it has less tendency to strip.

Fig. 4 Durable Thread Design

Cedarberg Snap-Loc Systems have milled, not turned, threads. This results in better starting threads, and less cross threading. Threads are easier to re-use.

FEATURES:

- Industrial Grade
- Adjustable Length
- Easy Hand Assembly
- Unrestricted Flow
- No Vibration Wandering
- Chemical Resistance
- Electrically Non-Conductive
- 3-Dimensional Adjustability

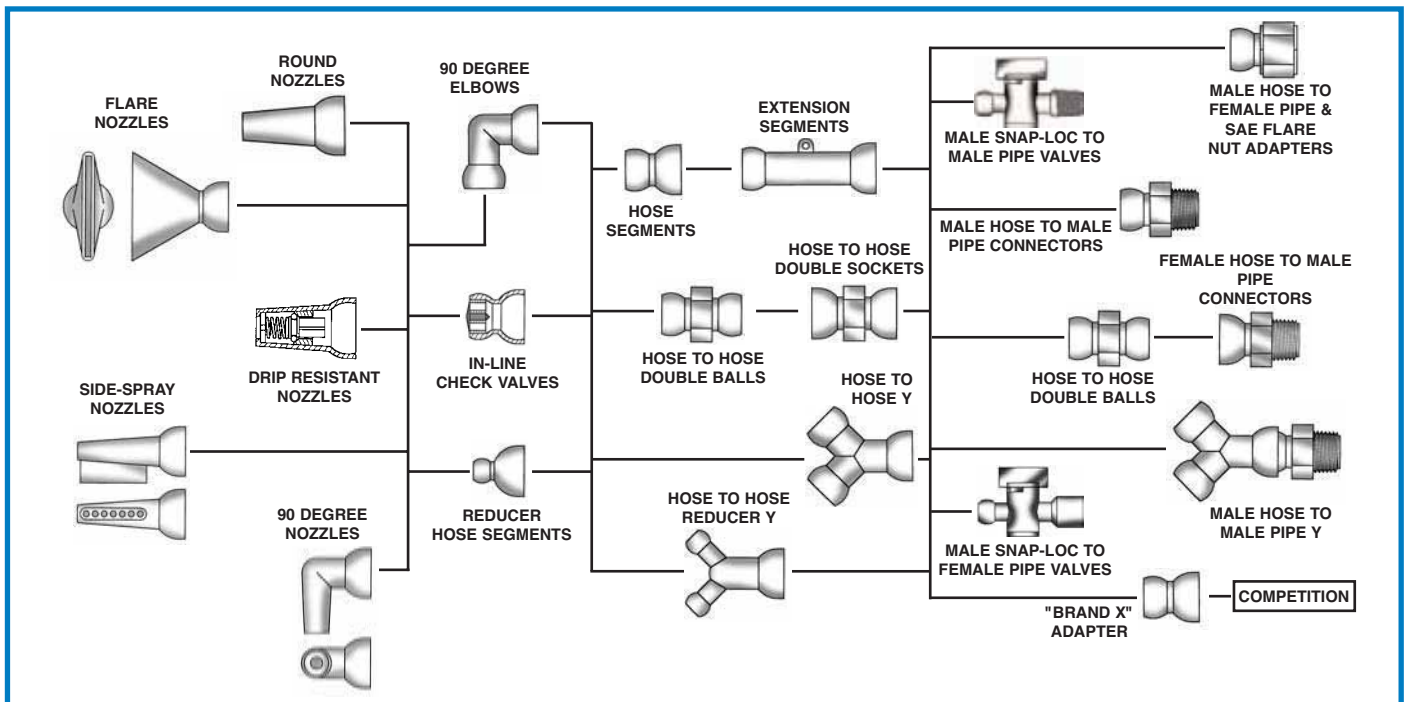

Snap-Loc Systems

More Than Just A Coolant Hose...



- Flexible Arms
- Flexible Arms• Air/Liquid/Vacuum Hose
- Air/Liquid/Vacuum Hose
- Goosenecks• Support Armatures

More Than Just A Coolant Hose...

Since the beginning, Cedarberg Snap-Loc Systems have served metalworking industries worldwide. However, the 3-dimensional flexibility and holding power of our design serves well in a wide range of applications. We work with product designers in many fields because our Snap-Loc Systems are ...**An Element of Ingenuity.**

"Thank you for your time and energy ... I have been awarded a scholarship with my research and development. Thank you again."
An Industrial Design Student

"Your assistance and interest in this project has made this possible. On behalf of the Design Team and Engineering, I would like to say, 'Thanks for a job well done.'"
A Recreational Equipment Manufacturer

Other Application Examples:

- Agri-business
- Applicators
- Aquariums
- Audio-Video
- Automotive
- Conduit
- Dispensers
- Display
- Electronics
- Ergonomics
- Fiber Optics
- Fillers
- Fountains
- Home & Garden
- Lab Instruments
- Lighting
- Material Handling
- Medical
- Optical Processing
- Parts Washers
- Photography
- Physical Rehabilitation
- Printing
- Recreation
- Sensors
- Spouts
- Stuffed Toy Armatures
- Transmitters



How Can Snap-Loc Systems Serve You?

Hose Assemblies & Parts

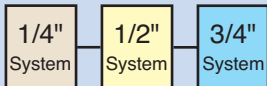

Extension Assemblies & Segments

Hose Assemblies & Segments

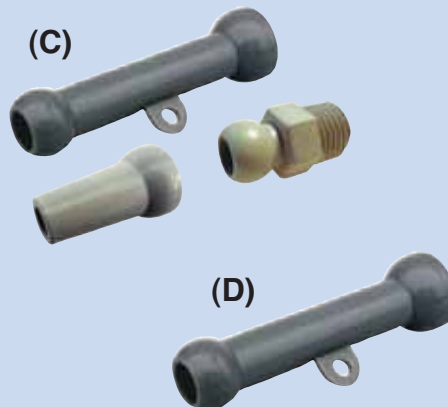
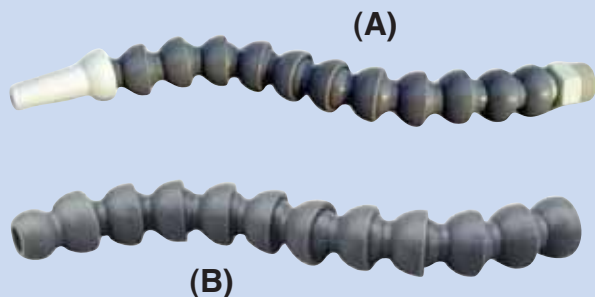

CAT. NO.	PRICE	DESCRIPTION	FIG. CODE
8425-11	\$8.70	Hose Assembly (A) (Approx. 13") Set Includes: 1/16", 1/8", 1/4" Nozzles; 1/8", 1/4" NPT Connectors	A
8525-157	\$8.70	Hose Assembly (A) (Approx. 13") Set Includes: 1/16", 1/8", 1/4" Nozzles 1/8", 1/4" BSPT Conn	A
8425-12	\$7.10	12" Segment Pac (B)	A
8425-21	\$146.00	25 Ft. Bulk Pac (B)	A
8425-22	\$280.50	50 Ft. Bulk Pac (B)	A
8525-228	\$545.00	100 Ft. Bulk Pac (B)	A
8425-170	\$7.10	12" Segment Pac (Blk) (B)	A
8425-118	\$146.00	25 Ft. Bulk (Black) (B)	A
8425-119	\$280.50	50 Ft. Bulk (Black) (B)	A
8425-120	\$545.00	100 Ft. Bulk (Black) (B)	A
8425-121	\$146.00	25 Ft. Bulk (Lt Gray) (B)	A
8425-122	\$280.50	50 Ft. Bulk (Lt Gray) (B)	A
8425-123	\$545.00	100 Ft. Bulk (Lt Gray) (B)	A
8525-243	\$146.00	25 Ft. Bulk (Red) (B)	A
8525-244	\$280.50	50 Ft. Bulk (Red) (B)	A
8525-245	\$545.00	100 Ft. Bulk (Red) (B)	A
8525-246	\$146.00	25 Ft. Bulk (Dk Blue) (B)	A
8525-247	\$280.50	50 Ft. Bulk (Dk Blue) (B)	A
8525-248	\$545.00	100 Ft. Bulk (Dk Blue) (B)	A

CAT. NO.	PRICE	DESCRIPTION	FIG. CODE
8450-11	\$9.95	Hose Assembly (A) (Approx. 13") Set Includes: 1/4", 3/8", 1/2" Nozzles; 3/8", 1/2" NPT Connectors	A
8550-175	\$9.95	Hose Assembly (A) (Approx. 13") Set Includes: 1/4", 3/8", 1/2" Nozzles; 3/8", 1/2" BSPT Connectors	A
8450-12	\$8.45	12" Segment Pac (B)	A
8450-21	\$171.40	25 Ft. Bulk Pac (B)	A
8450-22	\$332.20	50 Ft. Bulk Pac (B)	A
8550-211	\$655.00	100 Ft. Bulk Pac (B)	A
8450-155	\$8.45	12" Segment Pac (Blk) (B)	A
8450-118	\$171.40	25 Ft. Bulk (Black) (B)	A
8450-119	\$332.20	50 Ft. Bulk (Black) (B)	A
8450-120	\$655.00	100 Ft. Bulk (Black) (B)	A
8450-121	\$171.40	25 Ft. Bulk (Lt Gray) (B)	A
8450-122	\$332.20	50 Ft. Bulk (Lt Gray) (B)	A
8450-123	\$655.00	100 Ft. Bulk (Lt Gray) (B)	A
8550-236	\$171.40	25 Ft. Bulk (Red) (B)	A
8550-237	\$332.20	50 Ft. Bulk (Red) (B)	A
8550-238	\$655.00	100 Ft. Bulk (Red) (B)	A
8550-239	\$171.40	25 Ft. Bulk (Dk Blue) (B)	A
8550-240	\$332.20	50 Ft. Bulk (Dk Blue) (B)	A
8550-241	\$655.00	100 Ft. Bulk (Dk Blue) (B)	A

CAT. NO.	PRICE	DESCRIPTION	FIG. CODE
8475-11	\$12.40	Hose Assembly (A) (Approx. 12-1/2") Set Includes: 5/8" Nozzle; 3/4" NPT Connector	A
8475-11 BSP	\$12.40	Hose Assembly (A) (Approx. 12-1/2") Set Includes: 5/8" Nozzle; 3/4" BSPT Connector	A
8475-12	\$9.40	12-1/2" Seg Pac (B)	A
8475-21	\$202.95	25 Ft. Bulk Pac (B)	A
8475-22	\$390.50	50 Ft. Bulk Pac (B)	A
8475-29	\$760.00	100 Ft. Bulk Pac (B)	A
8475-118	\$202.95	25 Ft. Bulk (Black) (B)	A
8475-119	\$390.50	50 Ft. Bulk (Black) (B)	A
8475-120	\$760.00	100 Ft. Bulk (Black) (B)	A
8475-121	\$202.95	25 Ft. Bulk (Lt Gray) (B)	A
8475-122	\$390.50	50 Ft. Bulk (Lt Gray) (B)	A
8475-123	\$760.00	100 Ft. Bulk (Lt Gray) (B)	A
8475-124	\$202.95	25 Ft. Bulk (Red) (B)	A
8475-125	\$390.50	50 Ft. Bulk (Red) (B)	A
8475-126	\$760.00	100 Ft. Bulk (Red) (B)	A
8475-127	\$202.95	25 Ft. Bulk (Dk Blue) (B)	A
8475-128	\$390.50	50 Ft. Bulk (Dk Blue) (B)	A
8475-129	\$760.00	100 Ft. Bulk (Dk Blue) (B)	A

CAT. NO.	PRICE	DESCRIPTION	FIG. CODE
8425-154	\$11.25	Extension Assembly (C) (Approx. 12") Set Includes: 1/16", 1/8", 1/4" Nozzles; 1/8", 1/4" NPT Connectors	AB
8425-154 BSP	\$11.25	Extension Assembly (C) (Approx. 12") Set Includes: 1/16", 1/8", 1/4" Nozzles; 1/8", 1/4" BSPT Connectors	AB
8425-160	\$9.80	Extn Seg Pac of 6 (D)	AB
8425-161	\$39.50	Extn Seg Bag of 25 (D)	AB
8425-162	\$73.30	Extn Seg Bag of 50 (D)	AB
8425-163	\$140.90	Extn Seg Bag of 100 (D)	AB

CAT. NO.	PRICE	DESCRIPTION	FIG. CODE
8450-161	\$12.40	Extension Assembly (C) (Approx. 12") Set Includes: 1/4", 3/8", 1/2" Nozzles; 3/8", 1/2" NPT Connector	AB
8450-161 BSP	\$12.40	Extension Assembly (C) (Approx. 12") Set Includes: 5/8" Nozzles; 3/4" BSPT Connectors	AB
8450-162	\$10.95	Extn Seg Pac of 5 (D)	AB
8450-163	\$43.95	Extn Seg Bag of 25 (D)	AB
8450-164	\$81.20	Extn Seg Bag of 50 (D)	AB
8475-165	\$157.85	Extn Seg Bag of 100 (D)	AB

CAT. NO.	PRICE	DESCRIPTION	FIG. CODE
8475-54	\$14.35	Extension Assembly (C) (Approx. 12") Set Includes: 5/8" Nozzles; 3/4" NPT Connector	AB
8475-54 BSP	\$14.35	Extension Assembly (C) (Approx. 12") Set Includes: 5/8" Nozzles; 3/4" BSPT Connectors	AB
8475-55	\$12.85	Extn Seg Pac of 5 (D)	AB
8475-56	\$56.35	Extn Seg Bag of 25 (D)	AB
8475-57	\$101.45	Extn Seg Bag of 50 (D)	AB
8475-58	\$180.40	Extn Seg Bag of 100 (D)	AB

- Extension Segments (See Figs. C-D) may be used for fewer connections on long assemblies.
- All Extension Segments have a convenient eyelet for attaching to surrounding structures for extra long assemblies.
- Extension Assemblies also available with BSPT Connectors

Standard Material: Delrin 500
Polypropylene Available: Consult Factory
Standard Color: NPT Connectors Light Gray, BSPT Connectors Dark Gray, Hose Segments Dark Gray
 Other Colors Available (Consult Factory)

New Product Ideas:
 Cedarberg Industries welcomes new product ideas from our customers. We would be happy to receive your suggestions for new components or systems to expand and enhance our product line.

Connectors

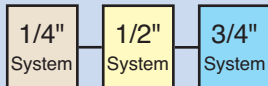

Connectors

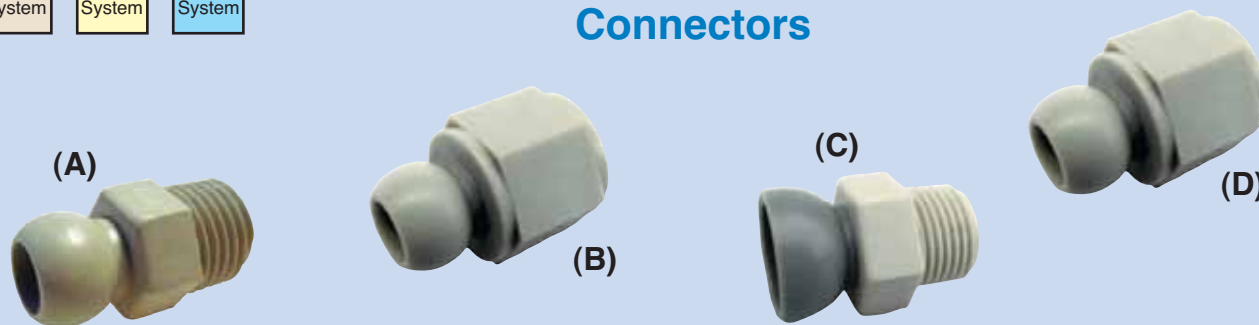

CAT. NO.	PRICE	DESCRIPTION	FIG. CODE
		Male Hose to Male Pipe Thread Connector (A)	
8425-17	\$4.85	1/8" NPT Pac of 4	A
8425-26	\$44.00	1/8" NPT Bag of 50	A
8425-18	\$4.85	1/4" NPT Pac of 4	A
8425-27	\$44.00	1/4" NPT Bag of 50	A
8525-177	\$4.85	1/8" BSPT Pac of 4	A
8525-178	\$43.95	1/8" BSPT Bag of 50	A
8525-179	\$4.85	1/4" BSPT Pac of 4	A
8525-180	\$43.95	1/4" BSPT Bag of 50	A

CAT. NO.	PRICE	DESCRIPTION	FIG. CODE
		Male Hose to Male Pipe Thread Connector (A)	
8450-17	\$5.05	3/8" NPT Pac of 4	A
8450-26	\$49.60	3/8" NPT Bag of 50	A
8450-18	\$5.05	1/2" NPT Pac of 4	A
8450-27	\$49.60	1/2" NPT Bag of 50	A
8550-164	\$5.10	3/8" BSPT Pac of 4	A
8550-165	\$49.60	3/8" BSPT Bag of 50	A
8550-166	\$5.10	1/2" BSPT Pac of 4	A
8550-167	\$49.60	1/2" BSPT Bag of 50	A
8450-235	\$5.05	3/4"-16 NF Pac of 4	A
8450-229	\$49.60	3/4"-16 NF Bag of 50	A

CAT. NO.	PRICE	DESCRIPTION	FIG. CODE
		Male Hose to Male Pipe Thread Connector (A)	
8475-18	\$6.15	3/4" NPT Pac of 4	A
8475-27	\$59.75	3/4" NPT Bag of 50	A
8475-18	\$6.15	3/4" BSPT Pac of 4	A
BSP			
8475-27	\$59.70	3/4" BSPT Bag of 50	A
BSP			

CAT. NO.	PRICE	DESCRIPTION	FIG. CODE
		Male Hose to Female Pipe Thread Connector (B)	
8525-199	\$7.10	1/8" FPT Pac of 4	A
8525-200	\$78.90	1/8" FPT Bag of 50	A
8525-197	\$7.10	1/4" FPT Pac of 4	A
8525-198	\$78.90	1/4" FPT Bag of 50	A

CAT. NO.	PRICE	DESCRIPTION	FIG. CODE
		Male Hose to Female Pipe Thread Connector (B)	
8550-182	\$9.60	3/8" FPT Pac of 4	A
8550-183	\$89.60	3/8" FPT Bag of 50	A
8550-188	\$9.60	1/2" FPT Pac of 4	A
8550-189	\$89.10	1/2" FPT Bag of 50	A

CAT. NO.	PRICE	DESCRIPTION	FIG. CODE

CAT. NO.	PRICE	DESCRIPTION	FIG. CODE
		Female Hose to Male Pipe Thread Connector (C)	
8525-103	\$7.10	1/8" NPT Pac of 2	A
8525-130	\$73.25	1/8" NPT Bag of 25	A
8525-104	\$7.10	1/4" NPT Pac of 2	A
8525-131	\$73.25	1/4" NPT Bag of 25	A
8525-167	\$7.10	1/8" BSPT Pac of 2	A
8525-191	\$73.25	1/8" BSPT Bag of 25	A
8525-170	\$7.10	1/4" BSPT Pac of 2	A
8525-192	\$73.25	1/4" BSPT Bag of 25	A

CAT. NO.	PRICE	DESCRIPTION	FIG. CODE
		Female Hose to Male Pipe Thread Connector (C)	
8550-104	\$8.45	3/8" NPT Pac of 2	A
8550-135	\$76.65	3/8" NPT Bag of 25	A
8550-105	\$8.45	1/2" NPT Pac of 2	A
8550-136	\$76.65	1/2" NPT Bag of 25	A
8550-180	\$8.45	3/8" BSPT Pac of 2	A
8550-186	\$76.65	3/8" BSPT Bag of 25	A
8550-181	\$8.45	1/2" BSPT Pac of 2	A
8550-187	\$76.65	1/2" BSPT Bag of 25	A

CAT. NO.	PRICE	DESCRIPTION	FIG. CODE
		Female Hose to Male Pipe Thread Connector (C)	
8475-112	\$11.25	3/4" NPT Pac of 2	A
8475-113	\$124.00	3/4" NPT Bag of 25	A

CAT. NO.	PRICE	DESCRIPTION	FIG. CODE
		SAE Flare Nut Adapter (D)	
8525-195	\$7.10	1/4" Pac of 4	A
8525-196	\$78.90	1/4" Bag of 50	A
8525-226	\$7.90	3/8" Pac of 4	A
8525-227	\$84.55	3/8" Bag of 50	A

CAT. NO.	PRICE	DESCRIPTION	FIG. CODE
		SAE Flare Nut Adapter (D)	
8550-176	\$8.45	3/8" Pac of 4	A
8550-177	\$89.10	3/8" Bag of 50	A

CAT. NO.	PRICE	DESCRIPTION	FIG. CODE

Standard Material: Delrin 500
Polypropylene Available: Consult Factory
Standard Color: NPT Connectors Light Gray, BSPT Connectors Dark Gray, Hose Segments Dark Gray

Standard Material: Delrin 500
Polypropylene Available: Consult Factory
Standard Color: NPT Connectors Light Gray, BSPT Connectors Dark Gray, Hose Segments Dark Gray

Standard Material: Delrin 500
Polypropylene Available: Consult Factory
Standard Color: NPT Connectors Light Gray, BSPT Connectors Dark Gray, Hose Segments Dark Gray

Round & Flare Nozzles

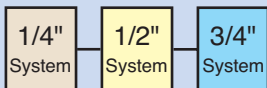

Round Nozzles



Flare Nozzles



CAT. NO.	PRICE	DESCRIPTION	CODE
8425-13	\$7.30	Nozzle Assortment Pac (1 each) 1/16", 1/8", 1/4" Round, 1" Flare 1/16" Nozzle	A
8425-14	\$4.85	Pac of 4	A
8425-23	\$42.50	Bag of 50	A
8425-110	\$42.50	Bag of 50 (Yellow)	A
8425-114	\$42.50	Bag of 50 (Orange)	A
8525-237	\$4.85	Pac of 4 (Delrin Dk Gray)	A
8525-240	\$42.85	Bag of 50 (Delrin Dk Gray) 1/8" Nozzle	A
8425-15	\$4.85	Pac of 4	A
8425-24	\$42.50	Bag of 50	A
8425-111	\$42.50	Bag of 50 (Yellow)	A
8425-115	\$42.50	Bag of 50 (Orange)	A
8525-238	\$4.85	Pac of 4 (Delrin Dk Gray)	A
8525-241	\$42.85	Bag of 50 (Delrin Dk Gray) 1/4" Nozzle	A
8425-16	\$4.85	Pac of 4	A
8425-25	\$42.50	Bag of 50	A
8425-112	\$42.50	Bag of 50 (Yellow)	A
8425-116	\$42.50	Bag of 50 (Orange)	A
8525-239	\$4.85	Pac of 4 (Delrin Dk Gray)	A
8525-242	\$42.85	Bag of 50 (Delrin Dk Gray)	A

CAT. NO.	PRICE	DESCRIPTION	CODE
		1" Flare Nozzle	
8425-19	\$7.10	Pac of 2	A
8425-28	\$53.00	Bag of 25	A
8425-113	\$52.50	Bag of 25 (Yellow)	A
8425-117	\$52.50	Bag of 25 (Orange)	A
8525-250	\$7.10	Pac of 2 (Delrin Dk Gray)	A
8525-251	\$53.00	Bag of 25 (Delrin Dk Gray)	A

CAT. NO.	PRICE	DESCRIPTION	CODE
8450-13	\$8.25	Nozzle Assortment Pac (1 each) 1/4", 3/8", 1/2" Round, 2" Flare 1/4" Nozzle	A
8450-14	\$5.05	Pac of 4	A
8450-23	\$48.50	Bag of 50	A
8450-110	\$48.50	Bag of 50 (Yellow)	A
8450-114	\$48.50	Bag of 50 (Orange)	A
8550-230	\$5.10	Pac of 4 (Delrin Dk Gray)	A
8550-233	\$48.50	Bag of 50 (Delrin Dk Gray) 3/8" Nozzle	A
8450-15	\$5.05	Pac of 4	A
8450-24	\$48.50	Bag of 50	A
8450-111	\$48.50	Bag of 50 (Yellow)	A
8450-115	\$48.50	Bag of 50 (Orange)	A
8550-231	\$5.10	Pac of 4 (Delrin Dk Gray)	A
8550-234	\$48.50	Bag of 50 (Delrin Dk Gray) 1/2" Nozzle	A
8450-16	\$5.05	Pac of 4	A
8450-25	\$48.50	Bag of 50	A
8450-112	\$48.50	Bag of 50 (Yellow)	A
8450-116	\$48.50	Bag of 50 (Orange)	A
8550-232	\$5.10	Pac of 4 (Delrin Dk Gray)	A
8550-235	\$48.50	Bag of 50 (Delrin Dk Gray)	A

CAT. NO.	PRICE	DESCRIPTION	CODE
		2" Flare Nozzle	
8450-19	\$8.45	Pac of 2	A
8450-28	\$69.90	Bag of 25	A
8450-113	\$69.80	Bag of 25 (Yellow)	A
8450-117	\$69.80	Bag of 25 (Orange)	A
8550-224	\$8.45	Pac of 2 (Delrin Dk Gray)	A
8550-225	\$69.90	Bag of 25 (Delrin Dk Gray)	A

CAT. NO.	PRICE	DESCRIPTION	CODE
		5/8" Nozzle	
8475-16	\$6.15	Pac of 4 (Delrin Dk Gray)	A
8475-25	\$59.75	Bag of 50 (Delrin Dk Gray)	A
8475-149	\$59.75	Bag of 50 (Orange)	A

CAT. NO.	PRICE	DESCRIPTION	CODE
		3" Flare Nozzle	
8475-19	\$9.90	Pac of 2	A
8475-28	\$92.45	Bag of 25	A
8475-148	\$92.45	Bag of 25 (Orange)	A
8475-106	\$9.90	Pac of 2 (Delrin Dk Gray)	A
8475-107	\$92.45	Bag of 25 (Delrin Dk Gray)	A

Standard Material: Polypropylene
 Delrin 500 Available: Consult Factory
 Standard Color: Light Gray, Other Colors Available

90° Fittings, Check Valves & Drip Resistant Nozzles

SNAP-LOC
Systems

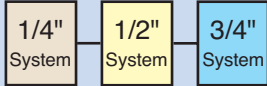

90° Nozzles



90° Elbows



Side Spray Nozzles



CAT. NO.	PRICE	DESCRIPTION	CODE
		1/4" 90° Elbow; Female Hose x Male Hose	
8425-181	\$6.10	Pac of 2	AB
8425-182	\$55.20	Bag of 25	AB

CAT. NO.	PRICE	DESCRIPTION	CODE
		1/2" 90° Elbow; Female Hose x Male Hose	
8450-196	\$6.85	Pac of 2	AB
8450-197	\$65.40	Bag of 25	AB

CAT. NO.	PRICE	DESCRIPTION	CODE
		3/4" 90° Elbow; Female Hose x Male Hose	
8475-136	\$8.45	Pac of 2	AB
8475-137	\$81.20	Bag of 25	AB

CAT. NO.	PRICE	DESCRIPTION	CODE
		90° Nozzles	
8425-183	\$5.05	1/4" x 1/8" 90° Nozzles Pac of 2	AC
8425-184	\$39.50	1/4" x 1/8" 90° Nozzles Bag of 25	AC
8425-185	\$5.05	1/4" x 1/4" 90° Nozzles Pac of 2	AC
8425-186	\$39.50	1/4" x 1/4" 90° Nozzles Bag of 25	AC

CAT. NO.	PRICE	DESCRIPTION	CODE
		90° Nozzles	
8450-198	\$5.65	1/2" x 1/4" 90° Nozzles Pac of 2	AC
8450-199	\$42.85	1/2" x 1/4" 90° Nozzles Bag of 25	AC
8450-200	\$5.65	1/2" x 3/8" 90° Nozzles Pac of 2	AC
8450-201	\$42.85	1/2" x 3/8" 90° Nozzles Bag of 25	AC

CAT. NO.	PRICE	DESCRIPTION	CODE
		90° Nozzles	
8475-138	\$7.30	3/4" x 5/8" 90° Nozzles Pac of 2	AC
8475-139	\$56.35	3/4" x 5/8" 90° Nozzles Bag of 25	AC

BENEFITS - 90° FITTINGS:

- Excellent for tight turns where space is limited.

CAT. NO.	PRICE	DESCRIPTION	CODE
		Side Spray Nozzles	
8425-187	\$6.55	1/4" Side Spray Nozzles Pac of 2	AC
8425-188	\$54.00	1/4" Side Spray Nozzles Bag of 25	AC

CAT. NO.	PRICE	DESCRIPTION	CODE
		Side Spray Nozzles	
8450-202	\$7.40	1/2" Side Spray Nozzles Pac of 2	AC
8450-203	\$62.00	1/2" Side Spray Nozzles Bag of 25	AC

CAT. NO.	PRICE	DESCRIPTION	CODE
		Side Spray Nozzles	
8475-140	\$8.15	3/4" Side Spray Nozzles Pac of 2	AC
8475-141	\$76.65	3/4" Side Spray Nozzles Bag of 25	AC

Valves

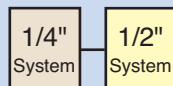

Plastic Snap-Loc Valves



CAT. NO.	PRICE	DESCRIPTION	CODE	CAT. NO.	PRICE	DESCRIPTION	CODE
8525-342	\$6.75	1/4" Male Snap-Loc x 1/4" Male NPT Black (1)	L	8525-344	\$6.75	1/4" Male Snap-Loc x 1/4" Female NPT Black (1)	L
8525-334	\$10.70	1/4" Male Snap-Loc x 1/4" Male NPT Black (2)	L	8525-340	\$10.70	1/4" Male Snap-Loc x 1/4" Female NPT Black (2)	L
8525-335	\$49.00	1/4" Male Snap-Loc x 1/4" Male NPT Black (10)	L	8525-341	\$49.00	1/4" Male Snap-Loc x 1/4" Female NPT Black (10)	L
8525-343	\$6.75	1/4" Male Snap-Loc x 1/4" Male BSPT Dk Gray (1)	L	8525-345	\$6.75	1/4" Male Snap-Loc x 1/4" Female BSPT Dk Gray (1)	L
8525-338	\$10.70	1/4" Male Snap-Loc x 1/4" Male BSPT Dk Gray (2)	L	8525-336	\$10.70	1/4" Male Snap-Loc x 1/4" Female BSPT Dk Gray (2)	L
8525-339	\$49.00	1/4" Male Snap-Loc x 1/4" Male BSPT Dk Gray (10)	L	8525-337	\$49.00	1/4" Male Snap-Loc x 1/4" Female BSPT Dk Gray (10)	L
8550-398	\$7.90	1/2" Male Snap-Loc x 1/2" Male NPT Black (1)	L	8550-400	\$7.90	1/2" Male Snap-Loc x 1/2" Female NPT Black (1)	L
8550-388	\$13.50	1/2" Male Snap-Loc x 1/2" Male NPT Black (2)	L	8550-394	\$13.50	1/2" Male Snap-Loc x 1/2" Female NPT Black (2)	L
8550-389	\$59.75	1/2" Male Snap-Loc x 1/2" Male NPT Black (10)	L	8550-395	\$59.75	1/2" Male Snap-Loc x 1/2" Female NPT Black (10)	L
8550-399	\$7.90	1/2" Male Snap-Loc x 1/2" Male BSPT Dk Gray (1)	L	8550-401	\$7.90	1/2" Male Snap-Loc x 1/2" Female BSPT Dk Gray (1)	L
8550-392	\$13.50	1/2" Male Snap-Loc x 1/2" Male BSPT Dk Gray (2)	L	8550-390	\$13.50	1/2" Male Snap-Loc x 1/2" Female BSPT Dk Gray (2)	L
8550-393	\$59.75	1/2" Male Snap-Loc x 1/2" Male BSPT Dk Gray (10)	L	8550-391	\$59.75	1/2" Male Snap-Loc x 1/2" Female BSPT Dk Gray (10)	L

Plastic Threaded Valves



CAT. NO.	PRICE	DESCRIPTION	CODE	CAT. NO.	PRICE	DESCRIPTION	CODE
8525-346	\$6.75	1/4" Male NPT x 1/4" Female NPT Black (1)	L	8525-352	\$6.75	1/4" Female NPT x 1/4" Female NPT Black (1)	L
8525-347	\$10.70	1/4" Male NPT x 1/4" Female NPT Black (2)	L	8525-353	\$10.70	1/4" Female NPT x 1/4" Female NPT Black (2)	L
8525-348	\$49.00	1/4" Male NPT x 1/4" Female NPT Black (10)	L	8525-354	\$49.00	1/4" Female NPT x 1/4" Female NPT Black (10)	L
8525-349	\$6.75	1/4" Male BSPT x 1/4" Female BSPT Dk Gray (1)	L	8525-355	\$6.75	1/4" Female BSPT x 1/4" Female BSPT Dk Gray (1)	L
8525-350	\$10.70	1/4" Male BSPT x 1/4" Female BSPT Dk Gray (2)	L	8525-356	\$10.70	1/4" Female BSPT x 1/4" Female BSPT Dk Gray (2)	L
8525-351	\$49.00	1/4" Male BSPT x 1/4" Female BSPT Dk Gray (10)	L	8525-357	\$49.00	1/4" Female BSPT x 1/4" Female BSPT Dk Gray (10)	L
8550-402	\$7.90	1/2" Male NPT x 1/2" Female NPT Black (1)	L	8550-408	\$7.90	1/2" Female NPT x 1/2" Female NPT Black (1)	L
8550-403	\$13.50	1/2" Male NPT x 1/2" Female NPT Black (2)	L	8550-409	\$13.50	1/2" Female NPT x 1/2" Female NPT Black (2)	L
8550-404	\$59.75	1/2" Male NPT x 1/2" Female NPT Black (10)	L	8550-410	\$59.75	1/2" Female NPT x 1/2" Female NPT Black (10)	L
8550-405	\$7.90	1/2" Male BSPT x 1/2" Female BSPT Dk Gray (1)	L	8550-411	\$7.90	1/2" Female BSPT x 1/2" Female BSPT Dk Gray (1)	L
8550-406	\$13.50	1/2" Male BSPT x 1/2" Female BSPT Dk Gray (2)	L	8550-412	\$13.50	1/2" Female BSPT x 1/2" Female BSPT Dk Gray (2)	L
8550-407	\$59.75	1/2" Male BSPT x 1/2" Female BSPT Dk Gray (10)	L	8550-413	\$59.75	1/2" Female BSPT x 1/2" Female BSPT Dk Gray (10)	L

Standard Material: Delrin 500.

Other Valves Available: Consult Factory.

Standard Colors: NPT Black, BSPT Dk Gray

The Pac

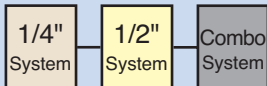

For Coolant Hose Set-Up And Quick Maintenance



CAT. NO.	PRICE	QTY	DESCRIPTION	CODE
8525-282	\$50.75		Kit Includes:	AB
		4	1/4" x 12" Hose Assy	
		1	1/4" Extension Segment	
		2	1/16" Round Nozzle	
		2	1/8" Round Nozzle	
		2	1/4" Round Nozzle	
		2	1" Flare Nozzle	
		3	1/8" Connector	
		3	1/4" Connector	
		2	1/4" Y	
		1	1/4" Double Ball	
		1	1/4" Double Socket	
		1	1/4" "Brand X" Adapter	
		1	1/4" Assembly Pliers	

CAT. NO.	PRICE	QTY	DESCRIPTION	CODE
8550-321	\$65.40		Kit Includes:	AB
		4	1/2" x 12" Hose Assy	
		1	1/2" Extension Segment	
		2	1/4" Round Nozzle	
		2	3/8" Round Nozzle	
		2	1/2" Round Nozzle	
		2	2" Flare Nozzle	
		3	3/8" Connector	
		3	1/2" Connector	
		2	1/2" Y	
		1	1/2" Y X 1/4" Reducer Y	
		1	1/2" Double Ball	
		1	1/2" Double Socket	
		1	1/2" "Brand X" Adapter	
		1	1/2" x 1/4" Adapter	
		1	1/2" Assembly Pliers	

CAT. NO.	PRICE	QTY	DESCRIPTION	CODE
8550-322	\$103.75		Kit Includes:	AB
		3	1/4" x 12" Hose Assy	
		3	1/2" x 12" Hose Assy	
		1	1/4" Extension Segment	
		1	1/2" Extension Segment	
		2	1/4" x 1/16" Round Nozzle	
		2	1/4" x 1/8" Round Nozzle	
		2	1/4" x 1/4" Round Nozzle	
		2	1/2" x 1/4" Round Nozzle	
		2	1/2" x 3/8" Round Nozzle	
		2	1/2" x 1/2" Round Nozzle	
		2	1/4" x 1" Flare Nozzle	
		2	1/2" x 2" Flare Nozzle	
		3	1/4" x 1/8" Connector	
		3	1/4" x 1/4" Connector	
		3	1/2" x 3/8" Connector	
		3	1/2" x 1/2" Connector	
		1	1/4" Y	
		1	1/2" Y	
		1	1/2" x 1/4" Reducer Y	
		1	1/4" Double Ball	
		1	1/4" Double Socket	
		1	1/2" Double Ball	
		1	1/2" Double Socket	
		1	1/4" "Brand X" Adapter	
		1	1/2" "Brand X" Adapter	
		1	1/2" x 1/4" Adapter	
		1	1/4" Assembly Pliers	
		1	1/2" Assembly Pliers	

Valves

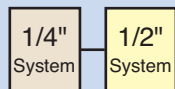

Plastic Snap-Loc Valves



CAT. NO.	PRICE	DESCRIPTION	CODE	CAT. NO.	PRICE	DESCRIPTION	CODE
8525-342	\$6.75	1/4" Male Snap-Loc x 1/4" Male NPT Black (1)	L	8525-344	\$6.75	1/4" Male Snap-Loc x 1/4" Female NPT Black (1)	L
8525-334	\$10.70	1/4" Male Snap-Loc x 1/4" Male NPT Black (2)	L	8525-340	\$10.70	1/4" Male Snap-Loc x 1/4" Female NPT Black (2)	L
8525-335	\$49.00	1/4" Male Snap-Loc x 1/4" Male NPT Black (10)	L	8525-341	\$49.00	1/4" Male Snap-Loc x 1/4" Female NPT Black (10)	L
8525-343	\$6.75	1/4" Male Snap-Loc x 1/4" Male BSPT Dk Gray (1)	L	8525-345	\$6.75	1/4" Male Snap-Loc x 1/4" Female BSPT Dk Gray (1)	L
8525-338	\$10.70	1/4" Male Snap-Loc x 1/4" Male BSPT Dk Gray (2)	L	8525-336	\$10.70	1/4" Male Snap-Loc x 1/4" Female BSPT Dk Gray (2)	L
8525-339	\$49.00	1/4" Male Snap-Loc x 1/4" Male BSPT Dk Gray (10)	L	8525-337	\$49.00	1/4" Male Snap-Loc x 1/4" Female BSPT Dk Gray (10)	L
8550-398	\$7.90	1/2" Male Snap-Loc x 1/2" Male NPT Black (1)	L	8550-400	\$7.90	1/2" Male Snap-Loc x 1/2" Female NPT Black (1)	L
8550-388	\$13.50	1/2" Male Snap-Loc x 1/2" Male NPT Black (2)	L	8550-394	\$13.50	1/2" Male Snap-Loc x 1/2" Female NPT Black (2)	L
8550-389	\$59.75	1/2" Male Snap-Loc x 1/2" Male NPT Black (10)	L	8550-395	\$59.75	1/2" Male Snap-Loc x 1/2" Female NPT Black (10)	L
8550-399	\$7.90	1/2" Male Snap-Loc x 1/2" Male BSPT Dk Gray (1)	L	8550-401	\$7.90	1/2" Male Snap-Loc x 1/2" Female BSPT Dk Gray (1)	L
8550-392	\$13.50	1/2" Male Snap-Loc x 1/2" Male BSPT Dk Gray (2)	L	8550-390	\$13.50	1/2" Male Snap-Loc x 1/2" Female BSPT Dk Gray (2)	L
8550-393	\$59.75	1/2" Male Snap-Loc x 1/2" Male BSPT Dk Gray (10)	L	8550-391	\$59.75	1/2" Male Snap-Loc x 1/2" Female BSPT Dk Gray (10)	L

Plastic Threaded Valves



CAT. NO.	PRICE	DESCRIPTION	CODE	CAT. NO.	PRICE	DESCRIPTION	CODE
8525-346	\$6.75	1/4" Male NPT x 1/4" Female NPT Black (1)	L	8525-352	\$6.75	1/4" Female NPT x 1/4" Female NPT Black (1)	L
8525-347	\$10.70	1/4" Male NPT x 1/4" Female NPT Black (2)	L	8525-353	\$10.70	1/4" Female NPT x 1/4" Female NPT Black (2)	L
8525-348	\$49.00	1/4" Male NPT x 1/4" Female NPT Black (10)	L	8525-354	\$49.00	1/4" Female NPT x 1/4" Female NPT Black (10)	L
8525-349	\$6.75	1/4" Male BSPT x 1/4" Female BSPT Dk Gray (1)	L	8525-355	\$6.75	1/4" Female BSPT x 1/4" Female BSPT Dk Gray (1)	L
8525-350	\$10.70	1/4" Male BSPT x 1/4" Female BSPT Dk Gray (2)	L	8525-356	\$10.70	1/4" Female BSPT x 1/4" Female BSPT Dk Gray (2)	L
8525-351	\$49.00	1/4" Male BSPT x 1/4" Female BSPT Dk Gray (10)	L	8525-357	\$49.00	1/4" Female BSPT x 1/4" Female BSPT Dk Gray (10)	L
8550-402	\$7.90	1/2" Male NPT x 1/2" Female NPT Black (1)	L	8550-408	\$7.90	1/2" Female NPT x 1/2" Female NPT Black (1)	L
8550-403	\$13.50	1/2" Male NPT x 1/2" Female NPT Black (2)	L	8550-409	\$13.50	1/2" Female NPT x 1/2" Female NPT Black (2)	L
8550-404	\$59.75	1/2" Male NPT x 1/2" Female NPT Black (10)	L	8550-410	\$59.75	1/2" Female NPT x 1/2" Female NPT Black (10)	L
8550-405	\$7.90	1/2" Male BSPT x 1/2" Female BSPT Dk Gray (1)	L	8550-411	\$7.90	1/2" Female BSPT x 1/2" Female BSPT Dk Gray (1)	L
8550-406	\$13.50	1/2" Male BSPT x 1/2" Female BSPT Dk Gray (2)	L	8550-412	\$13.50	1/2" Female BSPT x 1/2" Female BSPT Dk Gray (2)	L
8550-407	\$59.75	1/2" Male BSPT x 1/2" Female BSPT Dk Gray (10)	L	8550-413	\$59.75	1/2" Female BSPT x 1/2" Female BSPT Dk Gray (10)	L

Standard Material: Delrin 500.

Other Valves Available: Consult Factory.

Standard Colors: NPT Black, BSPT Dk Gray

Flood King/Manifold Kit

Flood King

Coolant And Cutting Fluid Flood System



CAT. NO.	PRICE	QTY	DESCRIPTION	CODE
8550-249	\$54.10		Flood King Kit Includes: 1 1/2" Ball Valve 4 1/2" x 12" Hose Assembly 4 Male Hose x 3/8" NPT Connectors 4 1/2" Nozzles 1 Manifold Block with Mounting Bracket 2 NPT Plugs	C

FEATURES:

- Valve Control
- Up to four hose lines
- Interchangeable nozzles with different diameters
- Flexible Snap-Loc hose for direct flow into flood area
- Vibration wandering eliminated
- Stays in place
- High chemical resistance
- Any length or shape instantly available
- Multiple uses



Universal Manifold Kit

CAT. NO.	PRICE	QTY	DESCRIPTION	CODE
8550-116	\$67.65		Universal Manifold Kit Kit Includes: 1 Manifold Block 1 Mounting Bracket 1 1/2" Female x 1/2" NPT Male Connector 1 1/2" NPT Ball Valve 2 1/2" NPT Close Nipple 3 3/8" NPT Close Nipple 6 3/8" NPT x 1/4" NPT Reducer Bushing 1 1/2" NPT Plug 1 3/8" NPT Plug 3 3/8" NPT Tee 2 1/4"-20 Hex Head Screw 2 1/4"-20 Hex Head Nut	C

Pipe Fittings

CAT. NO.	PRICE	DESCRIPTION	FIG. CODE
		Close Nipple Fittings (B)	
		1/4" NPT Close Nipple	
8525-115	\$5.85	Pac of 4	C
8525-135	\$28.20	Bag of 25	C
		3/8" NPT Close Nipple	
8537-101	\$7.45	Pac of 4	C
8537-109	\$35.35	Bag of 25	C
		1/2" NPT Close Nipple	
8550-118	\$8.60	Pac of 4	C
8550-138	\$41.25	Bag of 25	C
		Reducer Bushings (C)	
		3/8" NPT to 1/4" NPT	
8537-103	\$10.00	Pac of 4	C
8537-111	\$58.95	Bag of 25	C
		Tees 3/8" NPT (D)	
8537-100	\$6.15	Pac of 1	C
8537-108	\$25.90	Bag of 6	C
		Plugs (E)	
		3/8" NPT Plug	
8537-102	\$7.45	Pac of 4	C
8537-110	\$35.35	Bag of 25	C
		1/2" NPT Plug	
8550-119	\$10.00	Pac of 4	C
8550-139	\$58.90	Bag of 25	C

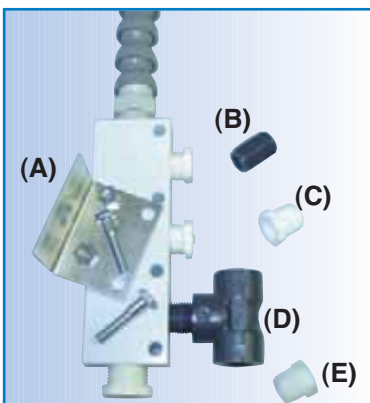

Manifold Kit Accessories

CAT. NO.	PRICE	DESCRIPTION	Fig. CODE
		Manifold Block & Mounting Bracket	(A)
8550-121	\$21.40	Pac of 1 Set	C
8550-140	\$107.10	Bag of 6 Sets	C

Magna-Flow/E-Z Mist

Magna-Flow

Efficient Flow Control To Deliver Air / Liquid Coolant Where It Is Needed



8525-262

FEATURES:

- Control valve allows convenient adjustment of air / coolant near work
- Barbed connection easily adapts to regulated shop air or machine coolant pump
- Magnetic Base (38 Lb. Pull) holds unit firmly in position
- Made of high quality non-corrosive materials
- Flexible hose can be easily directed and stays in position

BENEFITS:

- Extends tool life with precise coolant delivery
- Clears chips from work piece for easier visual inspection
- Great for EDM flushing
- Eliminates awkward support & adjustment
- Quickly transfers to other machines



8525-263

Replacement Parts

CAT. NO.	PRICE	DESCRIPTION	CODE
8525-262	\$36.10	Magna-Flow Single Pac Single 9" Length of 1/4" I.D. Hose 1/8" I.D. Nozzle	I
8525-263	\$40.60	Magna-Flow Dual Pac Two 9" Lengths of 1/4" I.D. Hose 1/8" I.D. Nozzle	I

APPLICATION NOTE:

- It is easy to adapt units for more nozzle outlets. Extra hose, Y-fittings, and nozzles may be purchased separately.

CAT. NO.	PRICE	DESCRIPTION	CODE
8702-043	\$20.00	Mag Base Assembly	II
8525-342	\$6.75	1/4" SL x MPT Valve	L

E-Z Mist

Reliable Mist Flow With Precision Control



FEATURES:

- Get the right mist mixture with separate air and fluid controls
- Fully assembled, ready to use
- No special tank required
- Magnetic base can be easily repositioned
- Made of high quality non-corrosive materials

BENEFITS:

- Extend tool life with optimal heat dissipation
- Allows correct mist mixture for any job
- Chemical savings
- Flexible hose stays in position to direct mist flow with ease
- Maintenance minimized by in-line coolant filter

CAT. NO.	PRICE	DESCRIPTION	CODE
8703-001	CALL	E-Z Mist Standard Control Kit Includes: 1/4" NPT Ball Valve 1/4" NPT Quick Disconnect 12" Hose Assembly with 1/8" Nozzle Aspirator Foot Strainer 3/8" O.D. Tubing Magnetic Base	I
8703-002	\$140.00	E-Z Mist Precision Control Kit Includes: 1/4" NPT Ball Valve 1/4" NPT Quick Disconnect 12" Hose Assembly with 1/8" Nozzle Pressure Gauge 1/4" Regulator Aspirator Foot Strainer 3/8" O.D. Tubing Magnetic Base	I

CAT. NO.	PRICE	DESCRIPTION	CODE
6460-001	CALL	Aspirator Assembly With Strainer	II
8702-043	\$20.00	Mag Base Assembly	II
8525-346	\$6.75	1/4" MPT x FPT Valve	L
6420-001	CALL	Regulator	II
6480-001	CALL	1" Diameter Pressure Gauge	II
6530-001	CALL	Strainer Assembly	II
6501-002	CALL	3/8" O.D. Plastic Tubing (1 Ft)	II
8703-004	CALL	Precision Regulator Gauge Kit	II
8703-006	CALL	E-Z Mist 12" Hose Assembly with 1/8" Nozzle	II

APPLICATION NOTES:

- **8703-001:** Requires regulated shop air. Ideal for general purpose mist applications
- **8703-002:** Built in regulator so shop air can be directly applied. Maintain close pressure tolerances for maximum misting efficiency and maximum cost savings

1/4" Snap-Loc Dimensions (Inches)

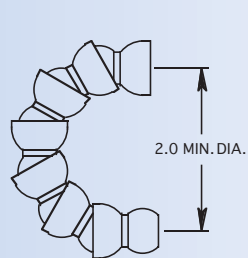

1/4" HOSE

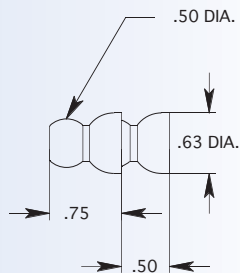

1/4" BODY SEGMENTS

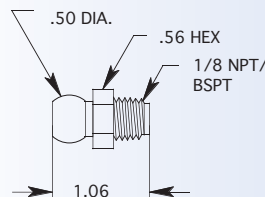

1/8" MALE CONNECTOR

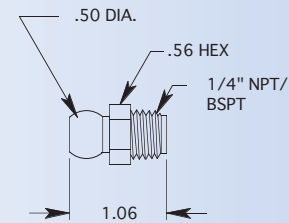

1/4" MALE CONNECTOR

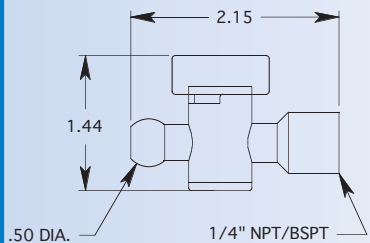

1/4" HOSE X 1/4" F NPT/F BSPT VALVE

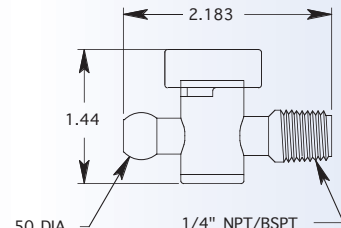

1/4" HOSE X 1/4" NPT/BSPT VALVE

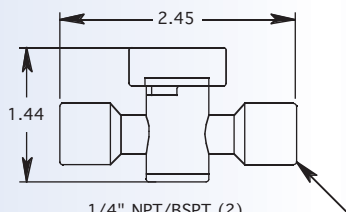

1/4" NPT/BSPT (2)
1/4" F NPT/BSPT X 1/4" F NPT/BSPT VALVE

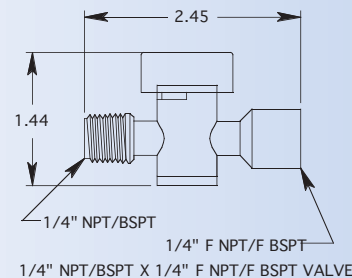

1/4" NPT/BSPT
1/4" F NPT/F BSPT
1/4" NPT/BSPT X 1/4" F NPT/F BSPT VALVE

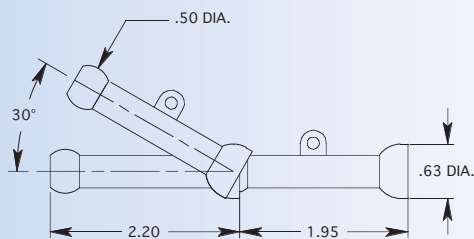

1/4" EXTENSION SEGMENTS

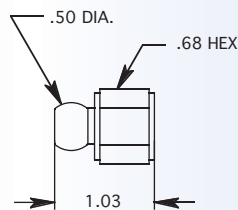

1/8" FPT FEMALE CONNECTOR
1/4" FPT FEMALE CONNECTOR

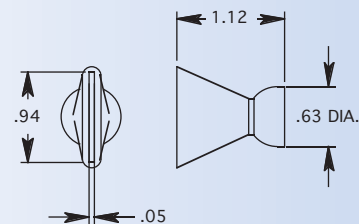

1" FLARE NOZZLE

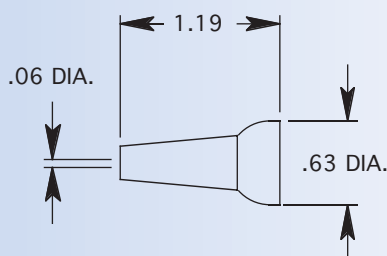

1/16" NOZZLE

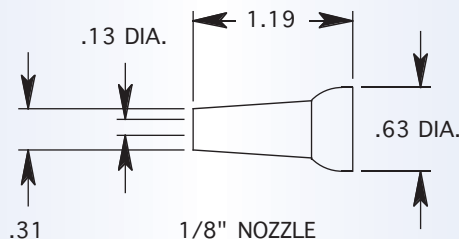

1/8" NOZZLE

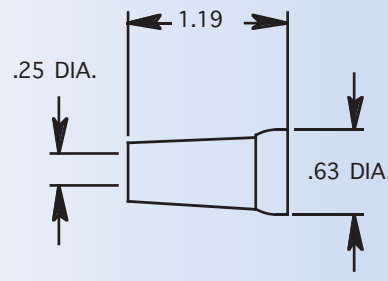

1/4" NOZZLE

Technical & Dimensional Data

1/4" Snap-Loc Dimensions (Inches)

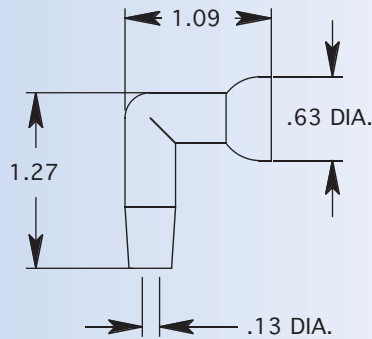

1/8" 90 DEGREE NOZZLE

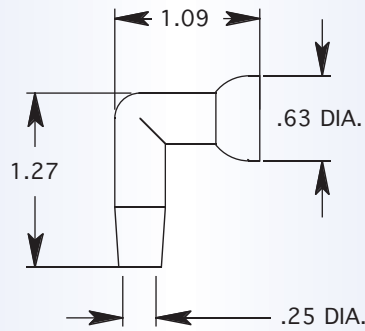

1/4" 90 DEGREE NOZZLE

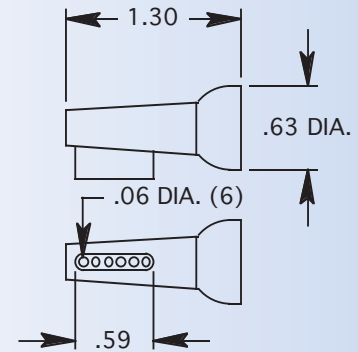

1/4" SIDE-SPRAY NOZZLE

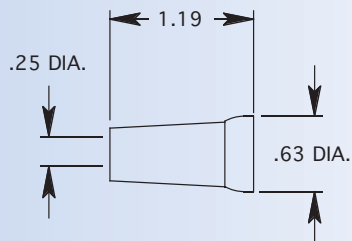

1/4" X 1/4" DRIP-RESISTANT NOZZLE

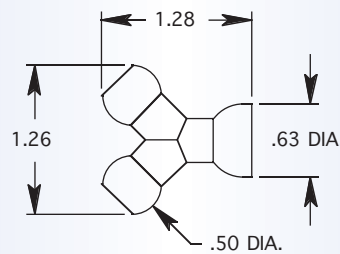

1/4" Y

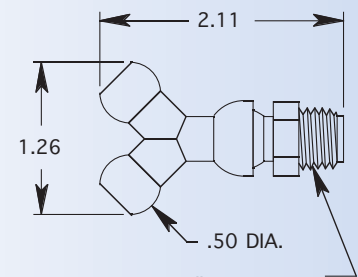

1/4" Y X 1/8" & 1/4" CONNECTOR MOLDED

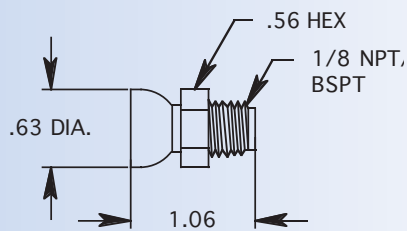

1/4" F HOSE X 1/8" CONNECTOR

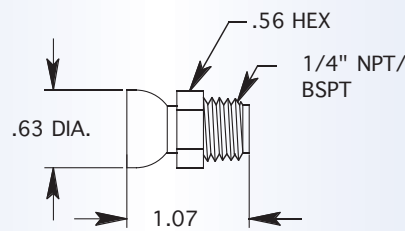

1/4" F HOSE X 1/4" CONNECTOR

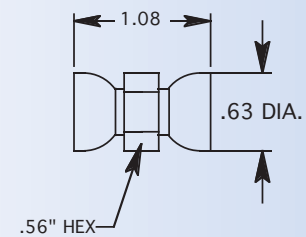

1/4" DOUBLE SOCKET ADAPTER

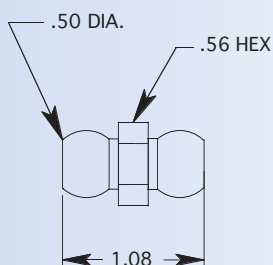

1/4" DOUBLE BALL ADAPTER

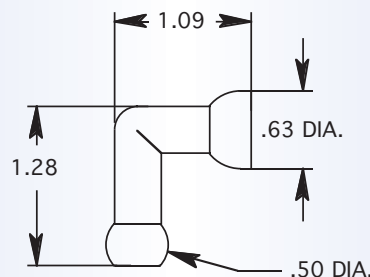

1/4" 90 DEGREE ELBOW

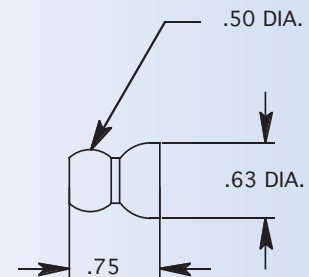

1/4" IN-LINE CHECK VALVE

1/2" Snap-Loc Dimensions (Inches)

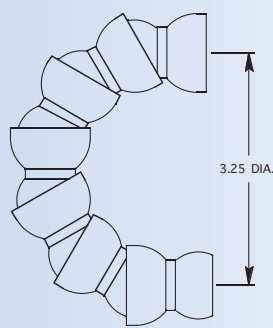

1/2" HOSE

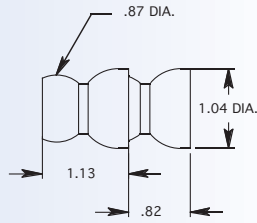

1/2" BODY SEGMENTS

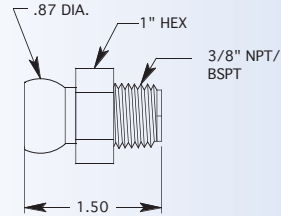

3/8" MALE CONNECTOR

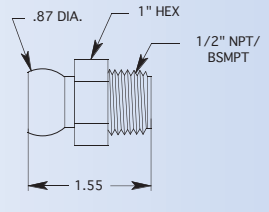

1/2" MALE CONNECTOR

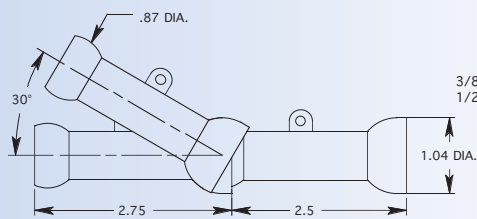

1/2" EXTENSION SEGMENTS

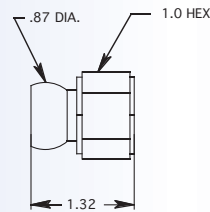

3/8" FPT FEMALE CONNECTOR
1/2" FPT FEMALE CONNECTOR

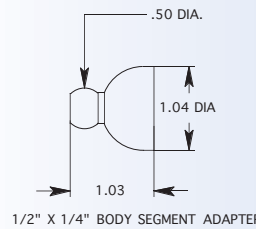

1/2" X 1/4" BODY SEGMENT ADAPTER

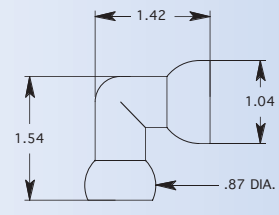

1/2" 90 DEGREE ELBOW

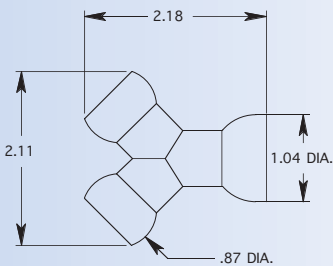

1/2" Y MOLDED

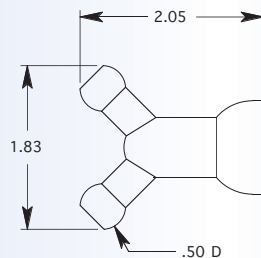

1/2" X 1/4" REDUCER Y - MOLDED STYLE

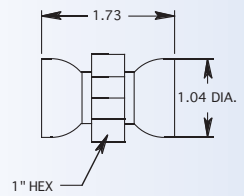

1/2" DOUBLE SOCKET ADAPTER

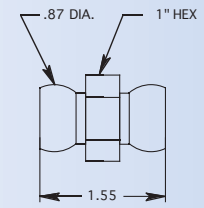

1/2" DOUBLE BALL ADAPTER

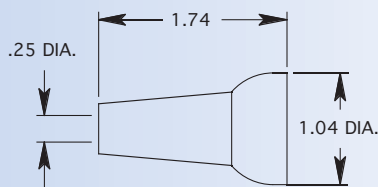

1/4" NOZZLE

1/4" NOZZLE

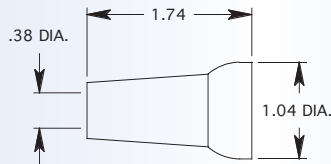

3/8" NOZZLE

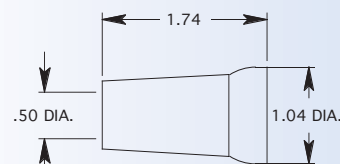

1/2" NOZZLE

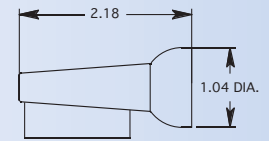

1/2" SIDE-SPRAY NOZZLE

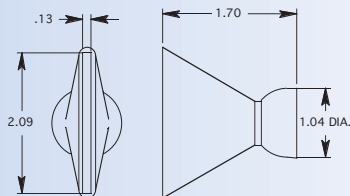

2" FLARE NOZZLE

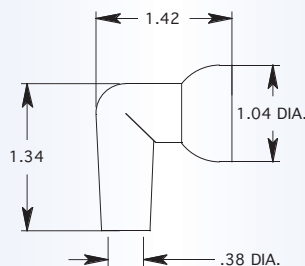

3/8" 90 DEGREE NOZZLE

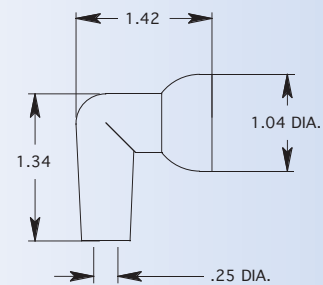

1/4" 90 DEGREE NOZZLE

Technical & Dimensional Data

1/2" Snap-Loc Dimensions (Inches)

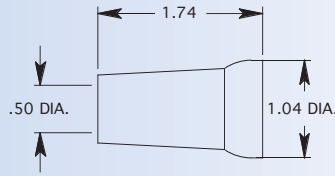

1/2" X 1/2" DRIP-RESISTANT NOZZLE

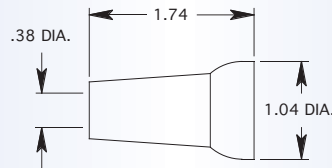

1/2" X 3/8" DRIP-RESISTANT NOZZLE

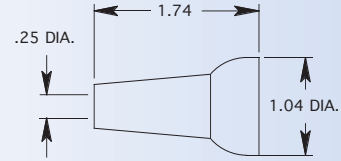

1/2" X 1/4" DRIP-RESISTANT NOZZLE

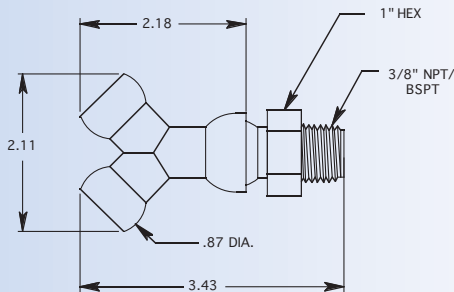

1/2" Y X 3/8" CONNECTOR

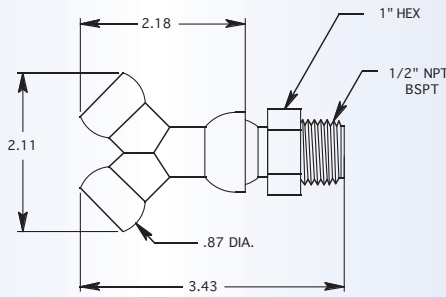

1/2" Y X 1/2" CONNECTOR

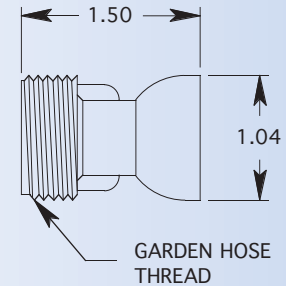

MALE GARDEN HOSE X FEMALE SNAP-LOC ADPTR

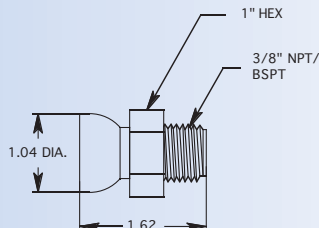

1/2" F HOSE X 3/8" CONNECTOR

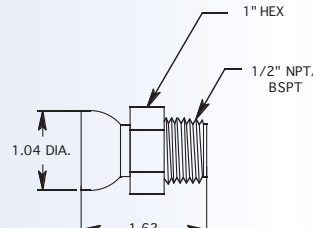

1/2" F HOSE X 1/2" CONNECTOR

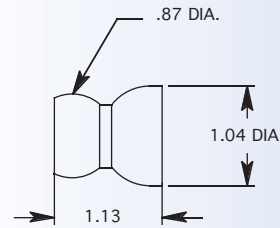

1/2" IN-LINE CHECK VALVE

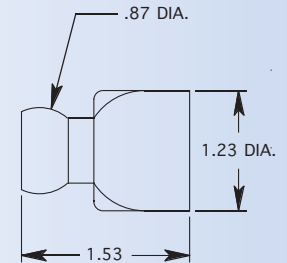

FEMALE GARDEN HOSE X MALE SNAP-LOC ADPTR

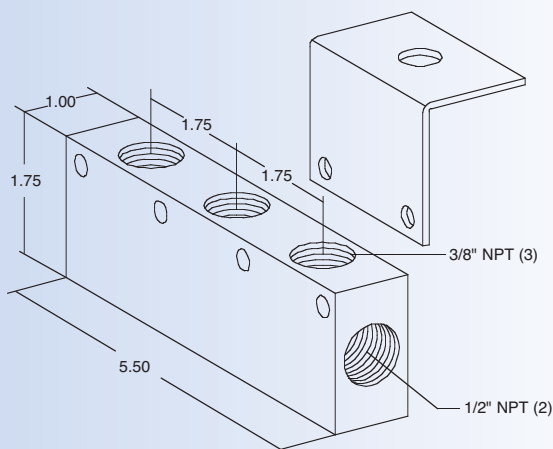

MANIFOLD BLOCK AND MOUNTING BRACKET

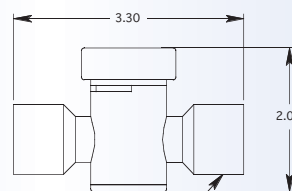

1/2" F NPT/F BSPT (2)
1/2" FEMALE NPT/BSPT X FEMALE NPT/F BSPT VALVE

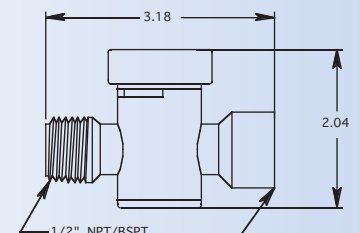

1/2" MALE NPT/BSPT X FEMALE NPT/BSPT VALVE

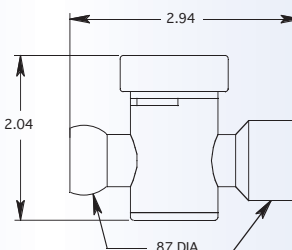

1/2" HOSE X FEMALE NPT/BSPT VALVE

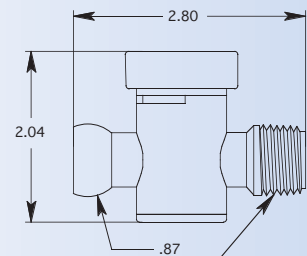

1/2" HOSE X MALE NPT/BSPT VALVE

3/4" Snap-Loc Dimensions (Inches)

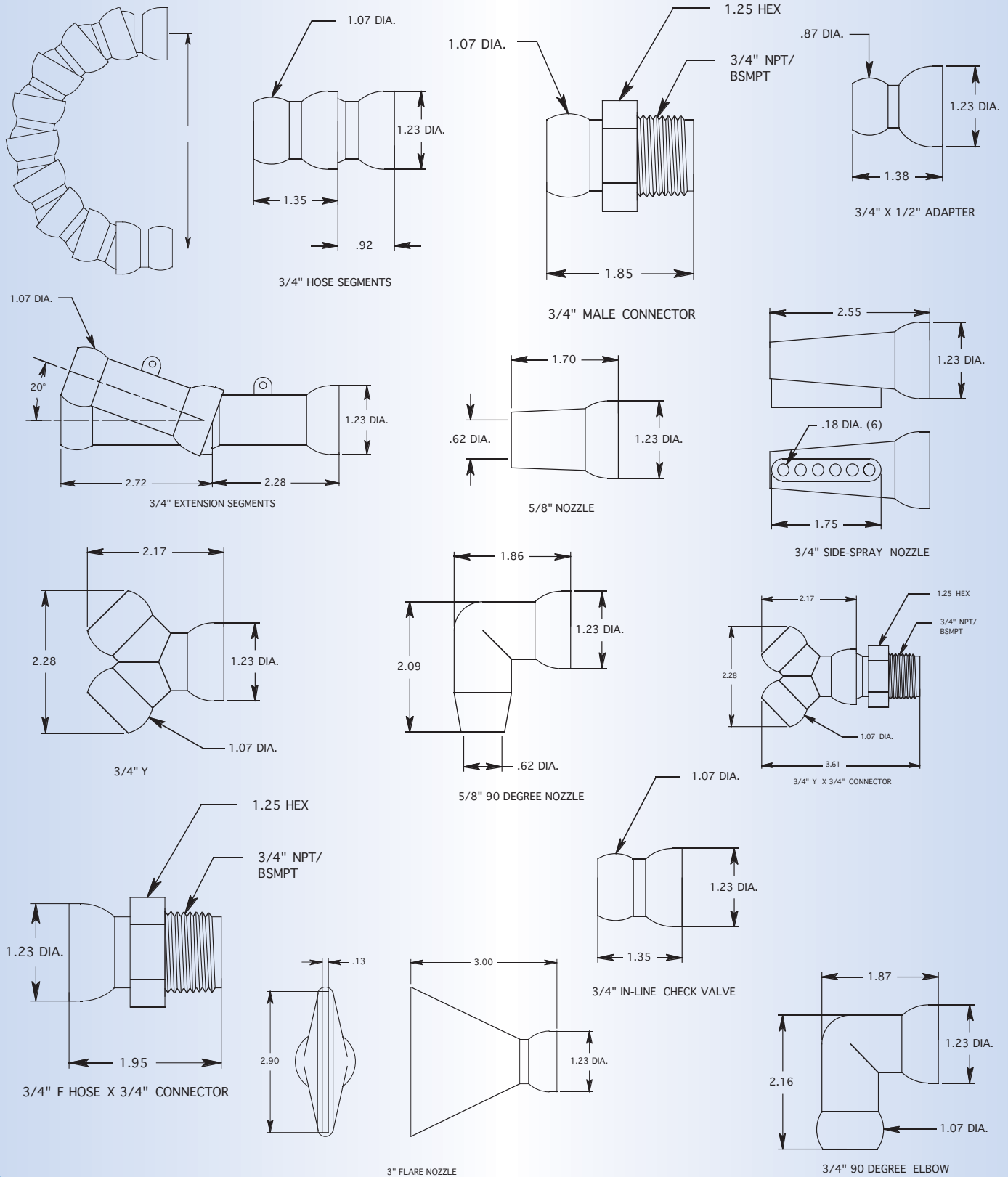

Technical & Dimensional Data

Interchangeable Components

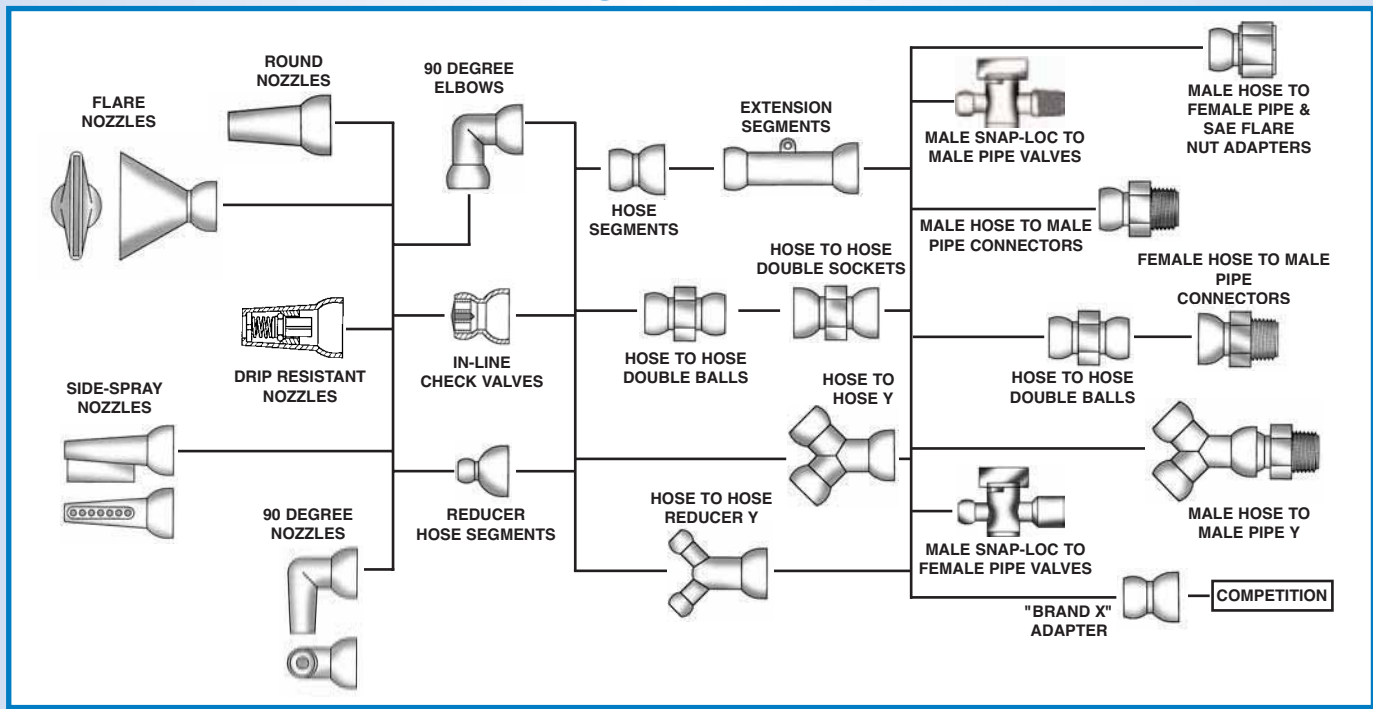

INTERCHANGEABLE COMPONENTS:

- Snap-Loc components are interchangeable; Reducers are available for 3/4" to 1/2" hose, and for 1/2" to 1/4" hose, allowing for the use of all three hose sizes in a single installation. "Brand X" adapters are available for connecting Snap-Loc Systems to competitive hoses.

EASY HAND ASSEMBLY:

- Snap-Loc assembly and disassembly is fast and easy. Assembly Pliers are available for the 1/4" and 1/2" Systems. The Universal Assembly Tool can be used for assembly of 1/4", 1/2" and 3/4" Systems. Separation Wedges for each of the three hose sizes simplify disassembly (Pg. 11).

HOSE BEND CAPABILITIES:

- Snap-Loc hose may be bent to form tight turns. Minimum center-line diameters are as follows:
 - 1/4" Hose; 2" center-line diameter
 - 1/2" Hose; 3-1/4" center-line diameter
 - 3/4" Hose; 5-1/4" center-line diameter

MATERIALS:

- Standard Snap-Loc Hose and Connector material is Delrin. Standard Nozzle material is

polypropylene. Consult factory for alternate material availability.

CHEMICAL RESISTANCE:

- Delrin exhibits superior chemical resistance to alcohols, aldehydes, esters, ethers, hydrocarbons (gasolines, lubricants, hydraulic fluid), agricultural chemicals, many weak acids and bases.
- Polypropylene provides good chemical resistance to a wide variety of chemical products, including alkalies, solvents, as well as acids.

WORKING PRESSURES:

- Snap-Loc Systems components are designed for normal shop air and fluid pressures. They are not intended for high pressure applications. Maximum operating pressure is dependent upon many factors, including temperature of solution, hose and nozzle size, and whether pressure is induced slowly or instantaneously.

WORKING TEMPERATURES:

- Maximum recommended working Temperature for Snap-Loc Systems is approximately 200° F (93°C).

Distributed By:

Phone, Fax or E-Mail for any of our catalogs.



Phone: 800-328-2279
Fax: 651-452-5350

Website: www.cedarberg.com
e-mail: info@cedarberg.com

Cedarberg Product Line Catalogs



Snap-Loc Systems



Consumer Products



Shop Accessories



Promotional Products





Phase Converters

CEDARBERG COMPANIES
1960 Seneca Road
Eagan, MN 55122 USA

PRSR STD
U. S. POSTAGE
PAID
Cedarberg Industries,
Inc.

cooling system

INTRODUCTION NOGA cooling systems were designed to answer various needs for cooling during machining, turning, drilling tapping etc. They are made in three different designs:

	page
 <p>NOGACOOOL</p>	<p>NOGACOOOL consists of a flexible Loc-Line® hose held by a magnet. It is used to easily direct cutting fluid from the coolant pump of machine tools towards the cutting area.</p> <p>3</p>
 <p>MINICOOL</p>	<p>With MINICOOL, an air + liquid mixture forms a fine spray that cools all metal-cutting operations.</p> <p>4-5</p>
 <p>COBRA</p>	<p>The COBRA drop-ejector shoots small quantities of liquid towards a distinct target. Various options enable the user to apply either single drops, or spray burst, or an air stream with small amounts of liquid.</p> <p>6-7</p>

NOGACOOOL



NOGACOOOL

NOGACOOOL consists of a manifold & Loc-Line® flexible hose with a nozzle on top and a valve at the bottom, assembled on the powerful on/off Popeye magnet.

The plug attached can be replaced by a second Loc-Line® hose.

NOGACOOOL is supplied with a set of three nozzles: 1/16", 1/8", 1/4".

Working conditions are as follows:
Pressure: 2-3.4 Bar (30-50 Psi)

Flow rate: 940 l/hour (250 gal/hour)
Max. working Temp. 170°C.

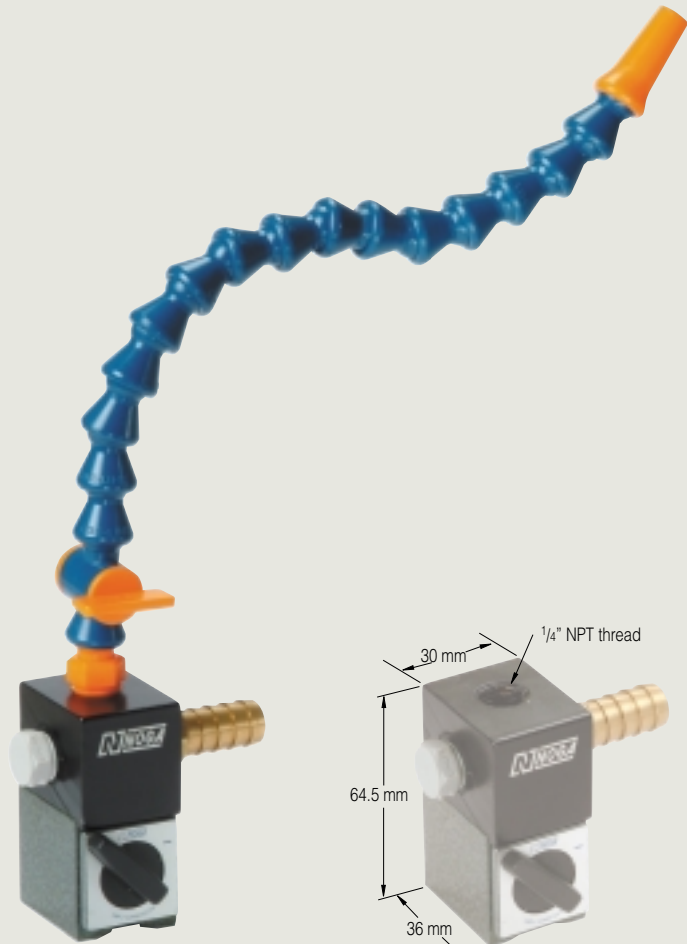

Also available with magnet and manifold only (order no. MC0161).



MC1601

MC0161

Spare parts

	Order no.
	320N Popeye magnet. Top thread M5 NF0037
	Manifold MC0156
	324 mm flexible Loc-Line® hose. Other dimensions available upon request. MC0320

	Order no.
	ø 1.6 mm plastic nozzle (1/16") MC0066
	ø 3.2 mm plastic nozzle (1/8") MC0063
	ø 6.3 mm plastic nozzle (1/4") MC0067
	Wide plastic nozzle, 16 holes ø 1 mm MC0072
	Wide plastic nozzle, 16 holes ø 1.5 mm MC0073

cooling system

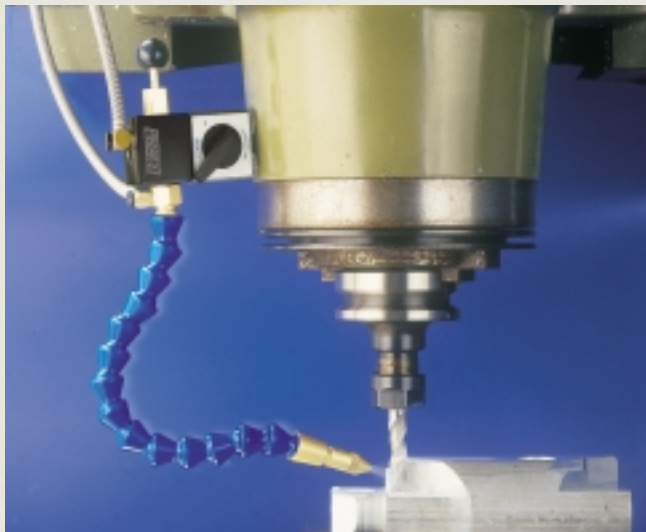

MINICOOL





NOGA MINICOOL is using the VENTURI principle to spray an air + liquid mixture. It consists of the following basic elements:

A control valve, spray unit, air line, syphon line and a powerful on/off Popeye magnet, which has a "V" form base, making it possible to mount on non-flat surfaces. The MINICOOL enables the user to easily control both the air flow rate and liquid rate.

Stainless steel armoured syphon hose and air hose are made in standard lengths: 1m, 2m, 3m (special lengths available upon request).

The spray unit comes in three standard lengths: 264, 334, 479 mm (special lengths available upon request).

Spare parts

	Order no.
	Control valve with Popeye magnet MC0130
	Spray unit 270 mm MC0101 Spray unit 340 mm MC0102 Spray unit 485 mm MC0103
	Air line 1 m MC0380 Air line 2 m MC0302
	Suction line 1 m MC0360 Suction line 2 m MC0311

	Order no.
	Valve stem MC0200
	Filter MC3637
	Washer MC0030
	Nuzzle nut MC0001
	Banjo screw + washer MC0232
	Banjo fitting MC0031

MINICOOL

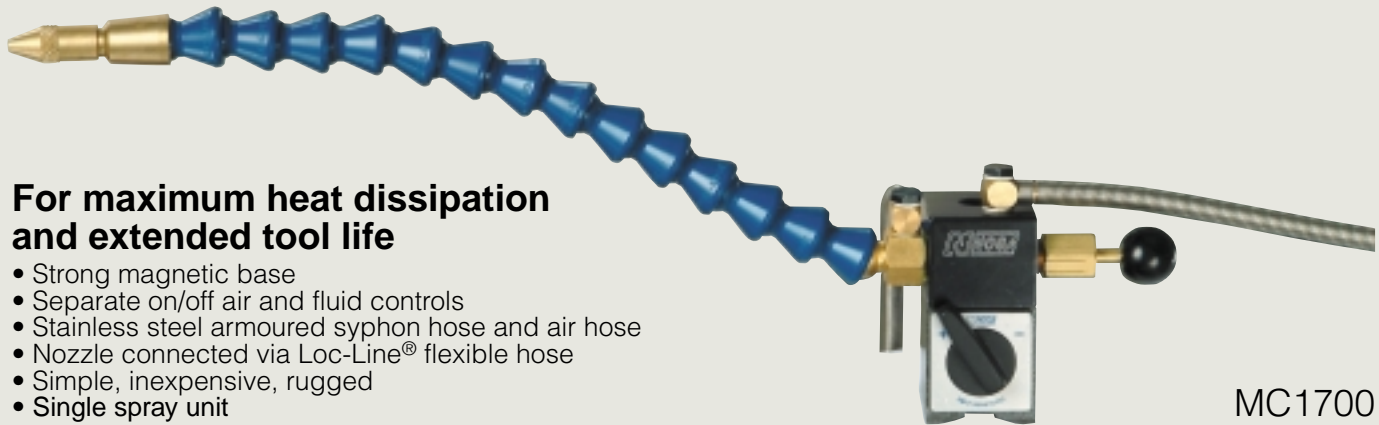

For maximum heat dissipation and extended tool life

- Strong magnetic base
- Separate on/off air and fluid controls
- Stainless steel armoured syphon hose and air hose
- Nozzle connected via Loc-Line® flexible hose
- Simple, inexpensive, rugged
- Single spray unit

MC1700

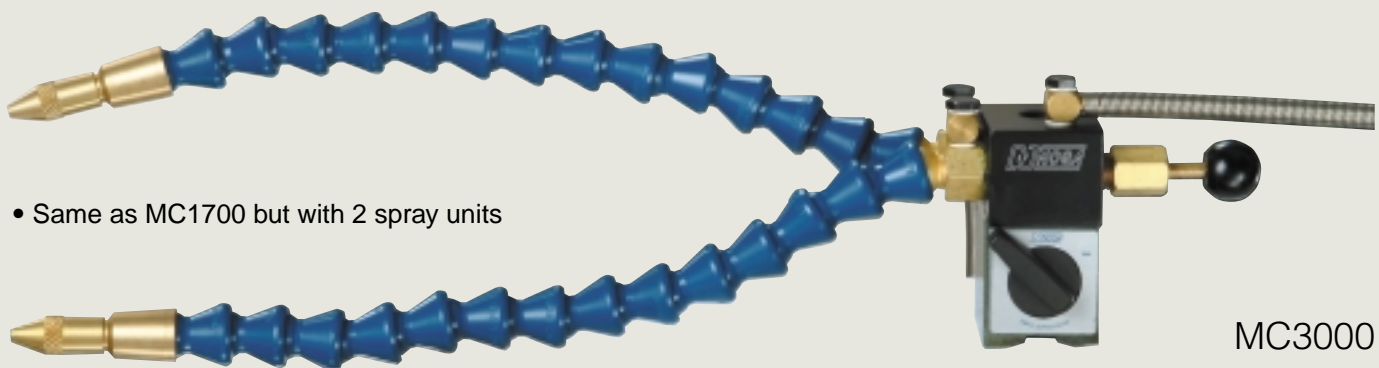

- Same as MC1700 but with 2 spray units

MC3000

MINICOOL order no.:

Air hose	Syphon hose	One spray unit of length (mm)			Two spray units of length (mm)		
		264	334	479	264	334	479
1 m	1 m	MC1700	MC1800	MC2000	MC3000	MC3100	MC3200
1 m	2 m	MC1710	MC1810	MC2010	MC3010	MC3110	MC3210
2 m	1 m	MC1720	MC1820	MC2020	MC3020	MC3120	MC3220
2 m	2 m	MC1730	MC1830	MC2030	MC3030	MC3130	MC3230





cooling system



COBRA

The COBRA drop ejector is designed to accurately shoot small quantities of liquid to distinct targets. An air actuated piston shoots the drops through a flexible hose onto the target. The drop shots can be automatically timed or manually determined by the user, the amount of liquid in each shot can also be adjusted by a tuning screw at the back of the COBRA all according to the user's needs. The COBRA is operated by clean air, pressure 3-9 bar. Most liquids and solvents up to 250 cst viscosity can be applied.

COBRA spare parts

		Order no.
	Banjo screw + washer	MC0232
	Banjo fitting	MC0031
	Nozzle nut	MC0001
	Washer	MC0030

OPERATING INSTRUCTIONS

The fluid can be supplied either by fitting the bowl (CB0146) directly onto the unit, or by using the large container (CB0147) and connecting it to the unit by 4 mm hose. Set up the pneumatic circuit as shown in one of the drawings (a) or (b) or (c). All connections are to be made with 4 mm hose.

Open drop size control nut "S" to maximum drop size. Start pulsing the unit by pressing the actuating valve many times, or operate the automatic pulse generator, until drops emerge.

Adjust the drop size to your needs.

If you have set up the circuit according to drawing (b) or (c), adjust the air flow with the nozzle nut "T".

- a. Setup for single drops using mechanical valve or automatic pulse generator

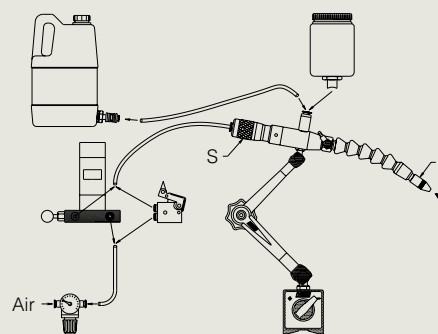

- b. Setup for finely dispersed droplets

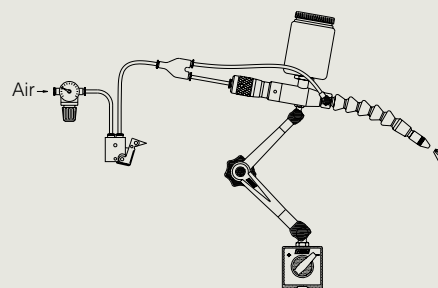

- c. Setup to supply drops and air jet independently

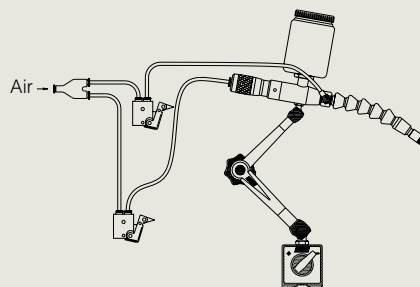

COBRA

Setup options and accessories

